

# 7" Inside 45° Corner

Scale 1" = 20"



www.creecast.com

**Inside 45° Corner** with two corner components (R / L).  
Wall part with unilateral bevel.

Effective length at rear side: 4' 0".

Effective length at visible side will be slightly smaller.

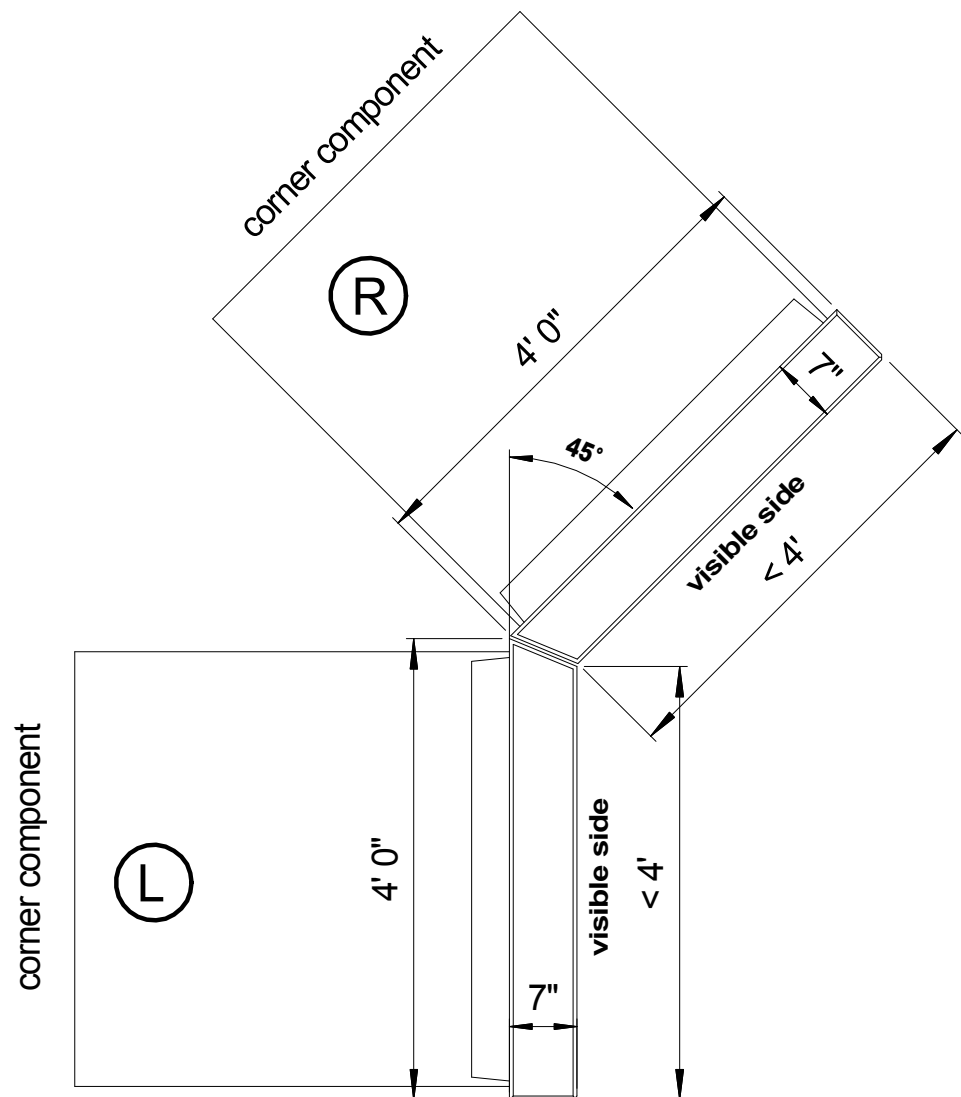

# 10" Inside 45° Corner

**Inside 45° Corner** with two corner components (R / L).  
Wall part with unilateral bevel.

Effective length at rear side: 4' 0".

Effective length at visible side will be slightly smaller.

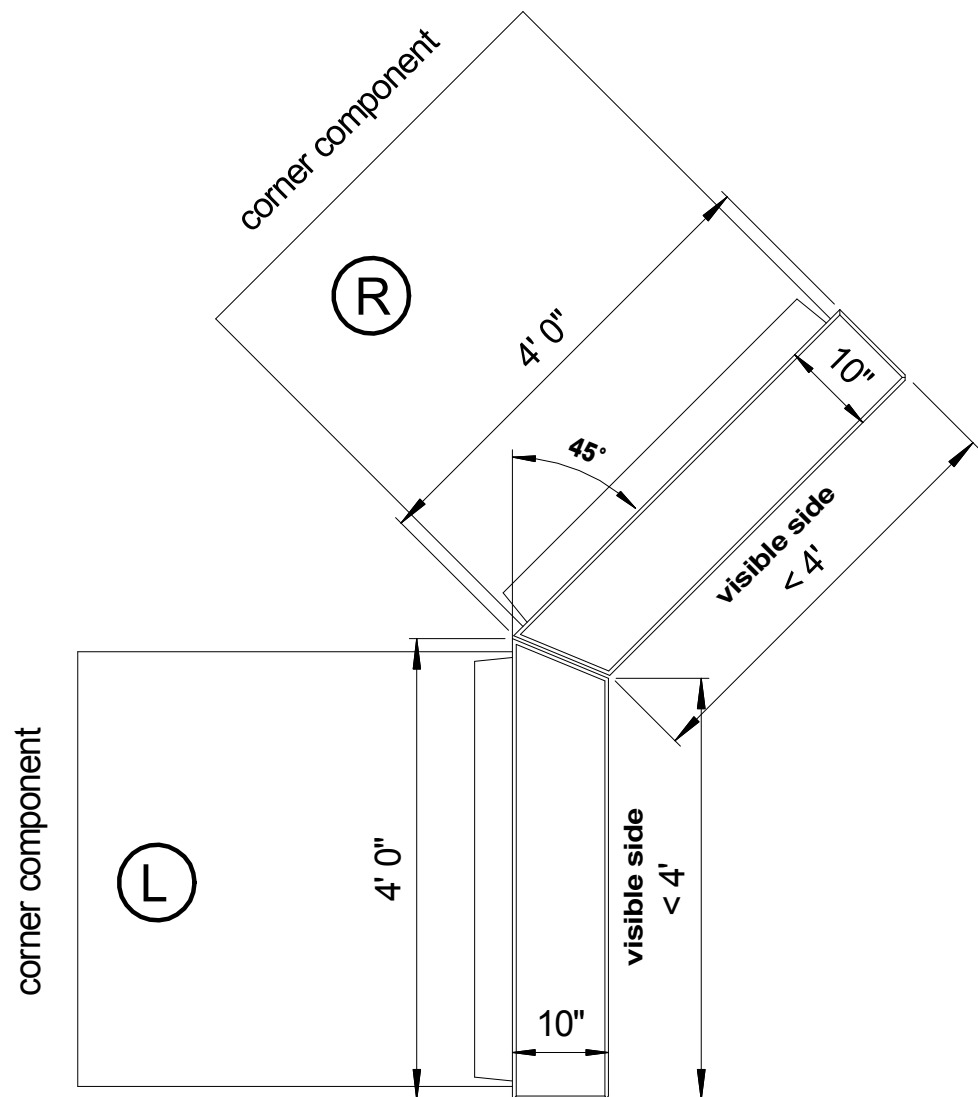

# 12" Inside 45° Corner

Scale 1" = 20"



www.crecast.com

**Inside 45° Corner** with two corner components (R / L).  
Wall part with unilateral bevel.

Effective length at rear side: 4' 0".

Effective length at visible side will be slightly smaller.

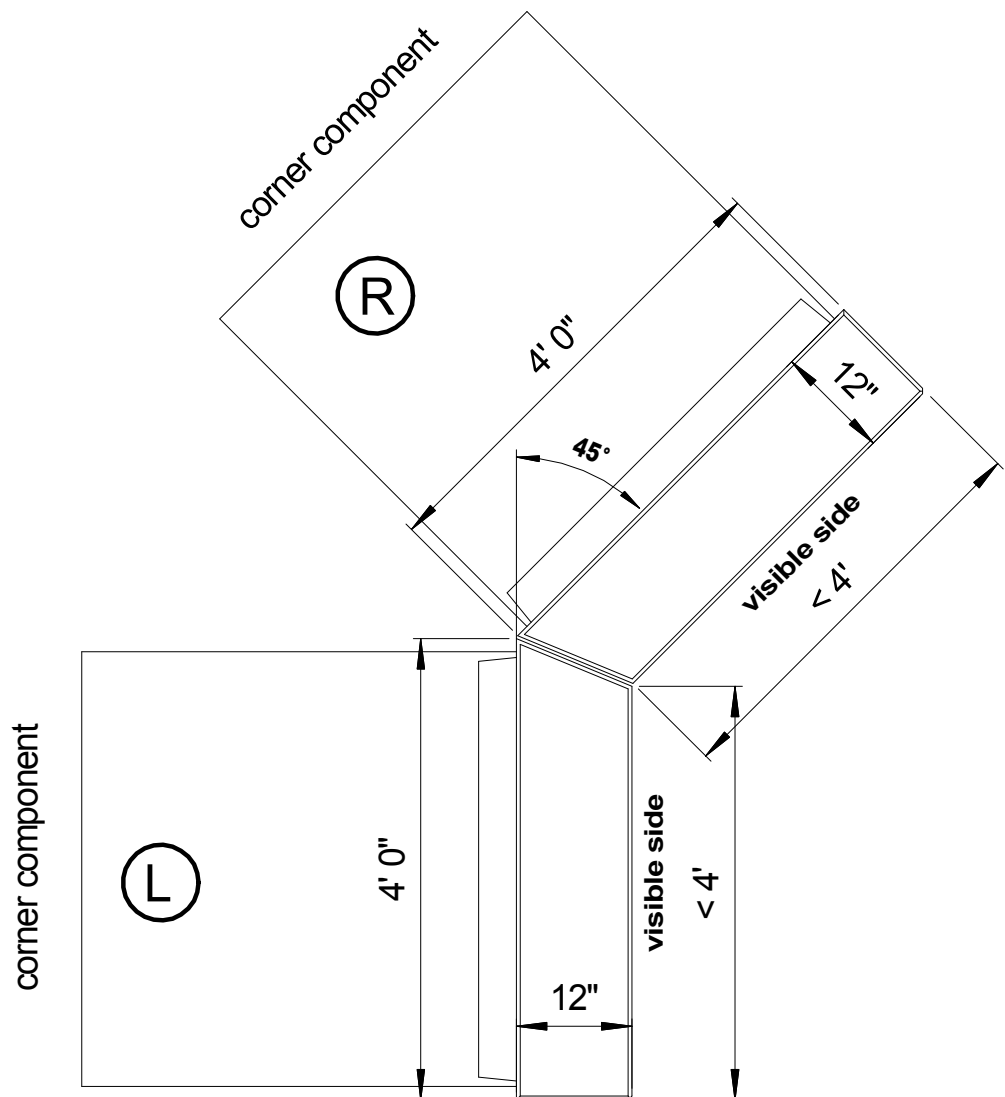

# 14" Inside 45° Corner

Scale 1" = 20"



www.crecast.com

**Inside 45° Corner** with two corner components (R / L).  
Wall part with unilateral bevel.

Effective length at rear side: 4' 0".

Effective length at visible side will be slightly smaller.

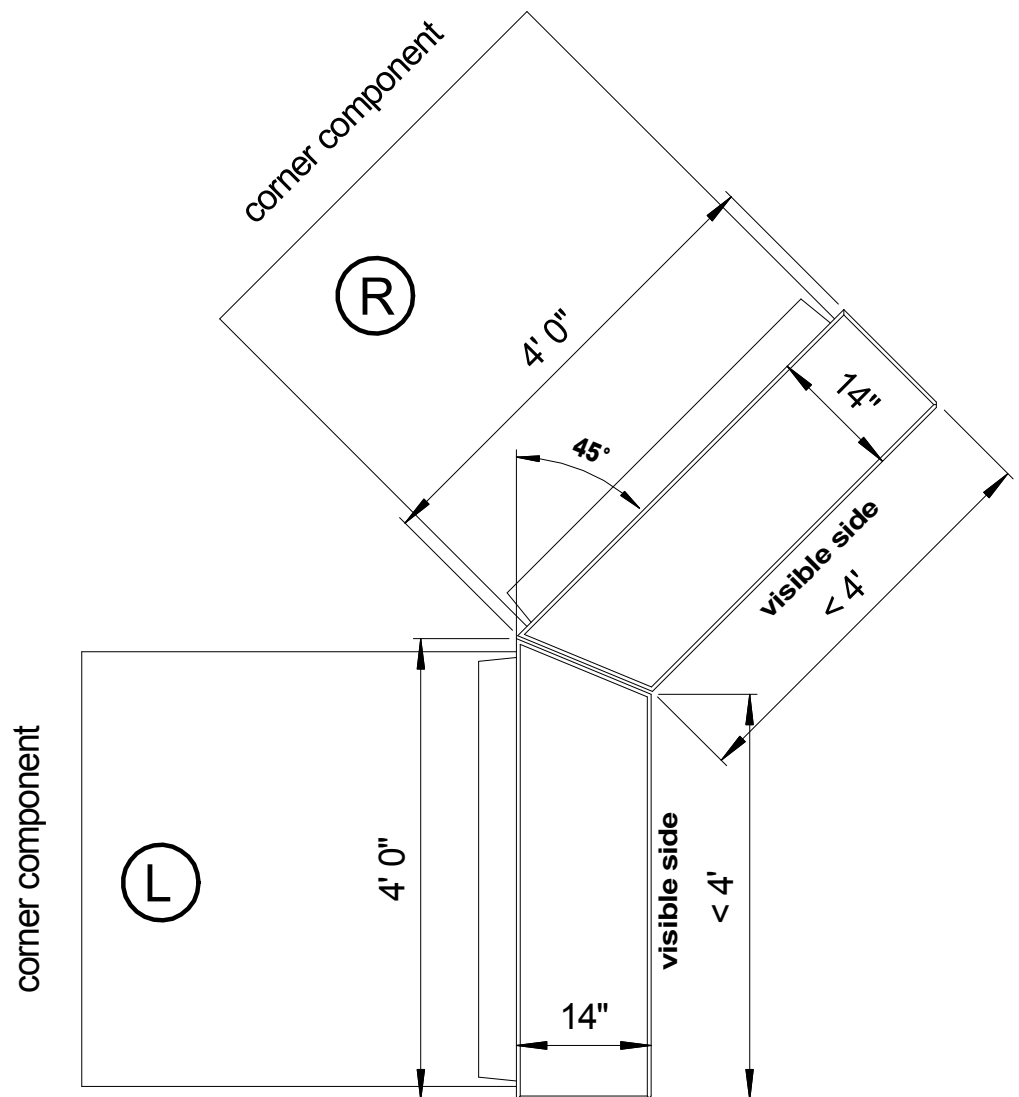

# 7" Inside 90° Corner

Scale 1" = 20"



www.crecast.com

**Inside 90° Corner** with standard components.

Effective length at visible side is 4' 0" and 3' 5" respectively.

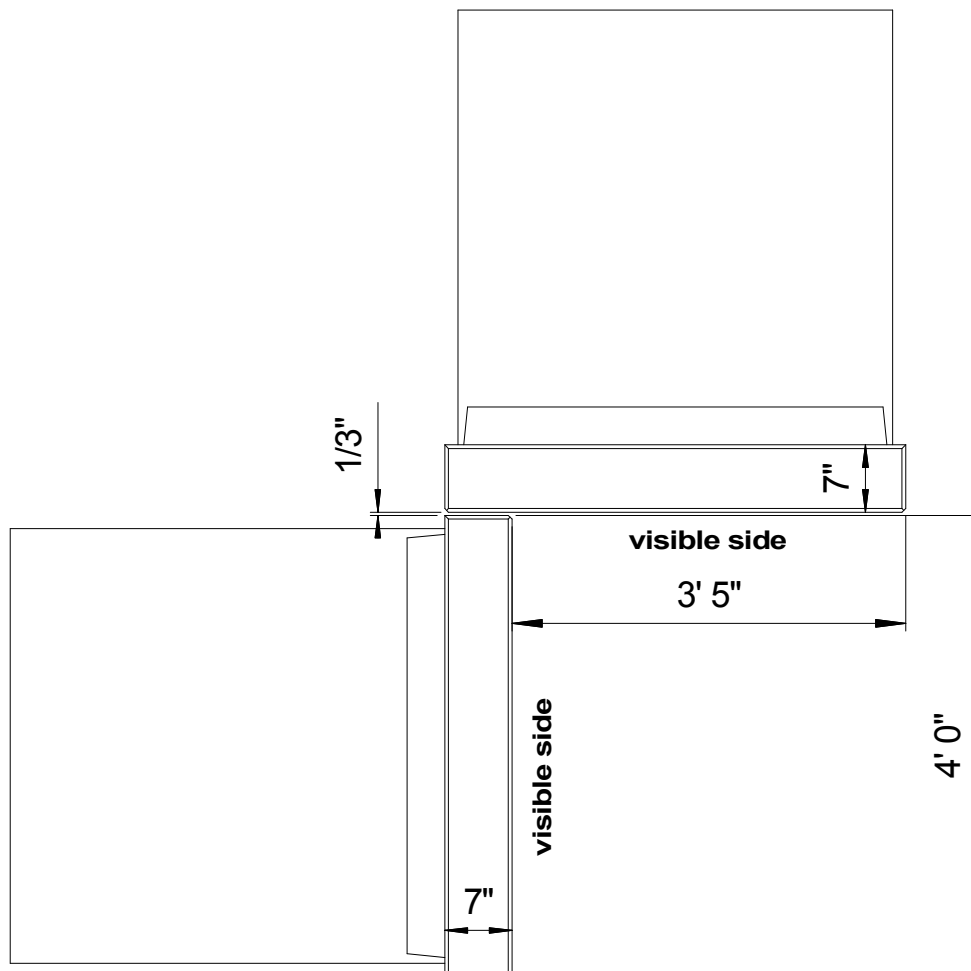

# 10" Inside 90° Corner

Scale 1" = 20"



www.crecast.com

**Inside 90° Corner** with standard components.

Effective length at visible side is 4' 0" and 3' 2" respectively.

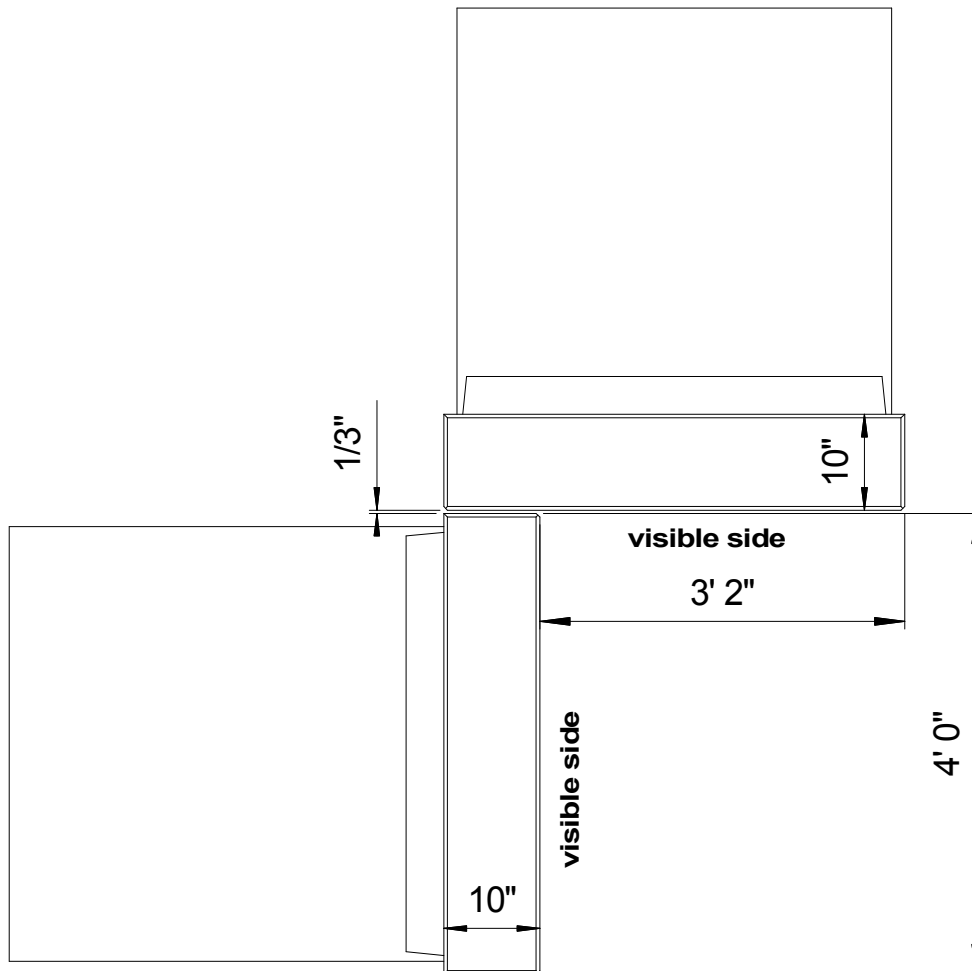

# 12" Inside 90° Corner

Scale 1" = 20"



www.crecast.com

**Inside 90° Corner** with standard components.

Effective length at visible side is 4' 0" and 3' 0" respectively.

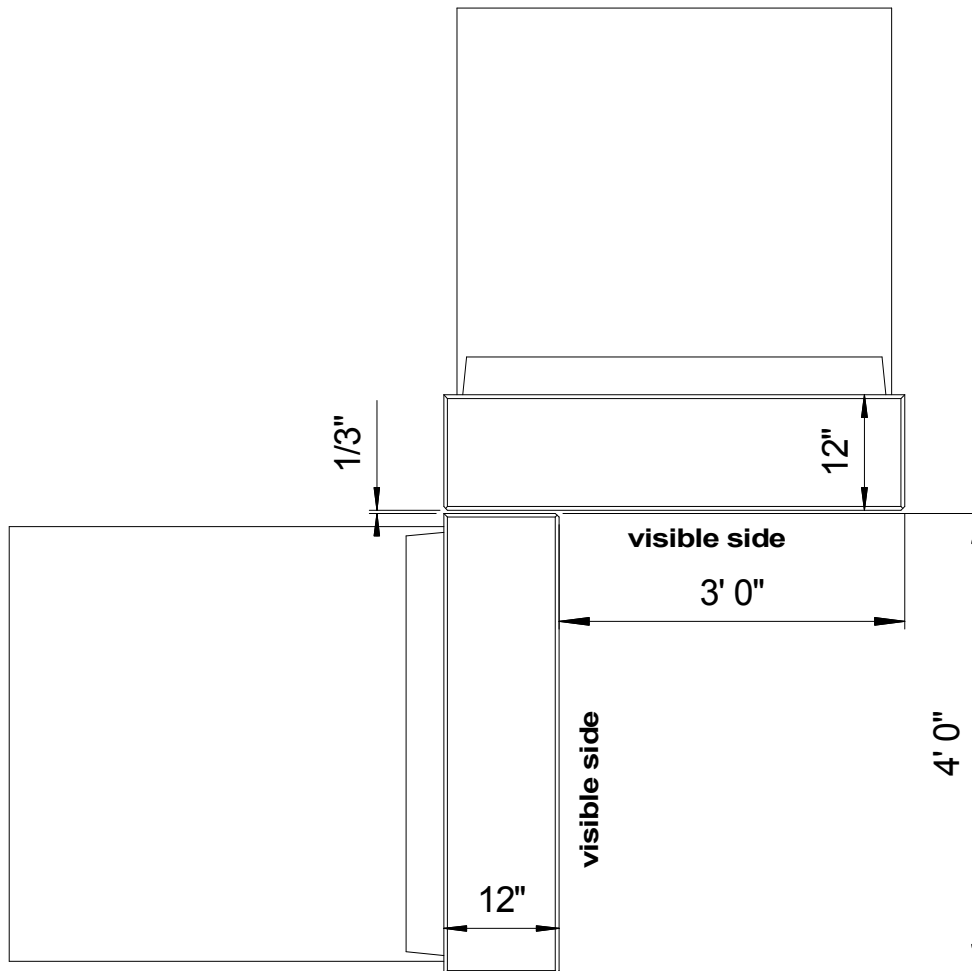

# 14" Inside 90° Corner

Scale 1" = 20"



www.creecast.com

**Inside 90° Corner** with standard components.

Effective length at visible side is 4' 0" and 2' 10" respectively.

